



Daling Way, London, , E3 5NL
£1,700 PCM

Elms Estates are pleased to be able to offer to the market for rent this three bedroom apartment situated on the 16th floor and offering stunning views across East London and beyond. The property is conveniently located next to the beautiful Victoria Park and within a short walk of Roman Road with its multiple shopping facilities. Ingram House is Available from 17th October and early viewing is highly recommended.



- Ext
- Lounge
- Kitchen
- Bedroom 1
- Bedroom 2
- bedroom 3
- Shower room

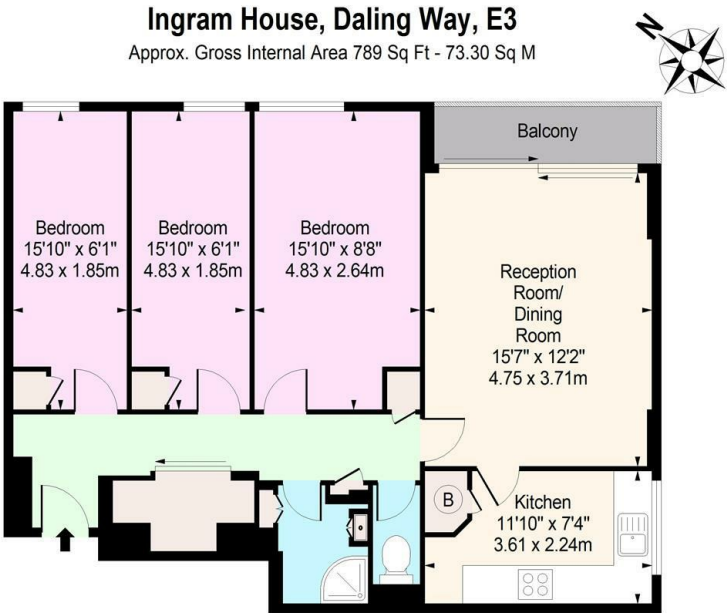

Sixteenth Floor
Floor Area 789 Sq Ft - 73.30 Sq M
For Illustration Purposes Only - Not To Scale
www.londonpropertyassessments.co.uk

Energy Efficiency Rating			Environmental Impact (CO ₂) Rating		
Very energy efficient - lower running costs			Very environmentally friendly - lower CO ₂ emissions		
(92 plus) A			(92 plus) A		
(81-91) B			(81-91) B		
(69-80) C			(69-80) C		
(55-68) D			(55-68) D		
(39-54) E			(39-54) E		
(21-38) F			(21-38) F		
(1-20) G			(1-20) G		
Not energy efficient - higher running costs			Not environmentally friendly - higher CO ₂ emissions		
England & Wales			England & Wales		
EU Directive 2002/91/EC			EU Directive 2002/91/EC		